

KINCROME

PROFESSIONAL QUALITY TOOLS

RATCHETING VEHICLE POSITIONING JACKS

**330MM
WHEEL
WIDTH
CAPACITY**

**STEEL
FRAME
CONSTRUCTION**

**ADJUSTING
RANGE
285MM-660MM**

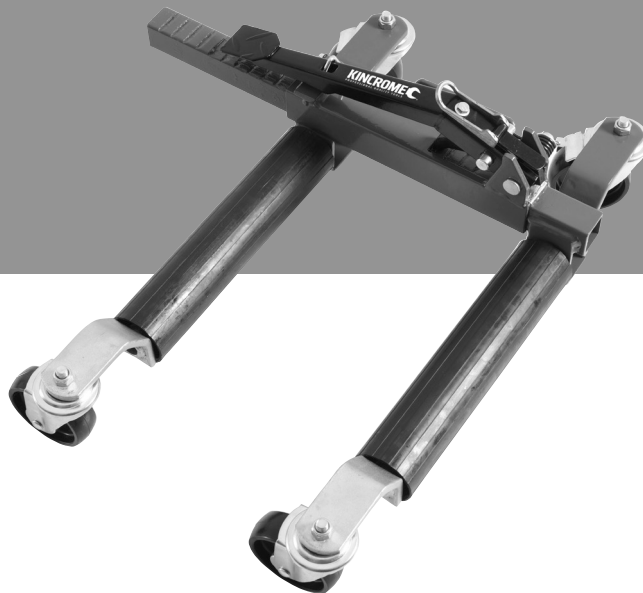

K12190 - Ratcheting Vehicle Positioning Jacks (Nylon Castors)

ED1/DEC19

Table of Contents

Know Your Product	2
Understanding Your Product	4
Assembly Instructions	5
Operation Instructions	5
Care & Maintenance	6
Trouble Shooting	7
Spare Parts & Exploded Diagram	8
Warranty	9

Know Your Product

1. Rear Locking Swivel Castors (x2)
2. Pump Pedal
3. Pedal Retaining Clip
4. Front Castors
5. Plastic Rollers
6. Locking Clip
7. Handle
8. Lever

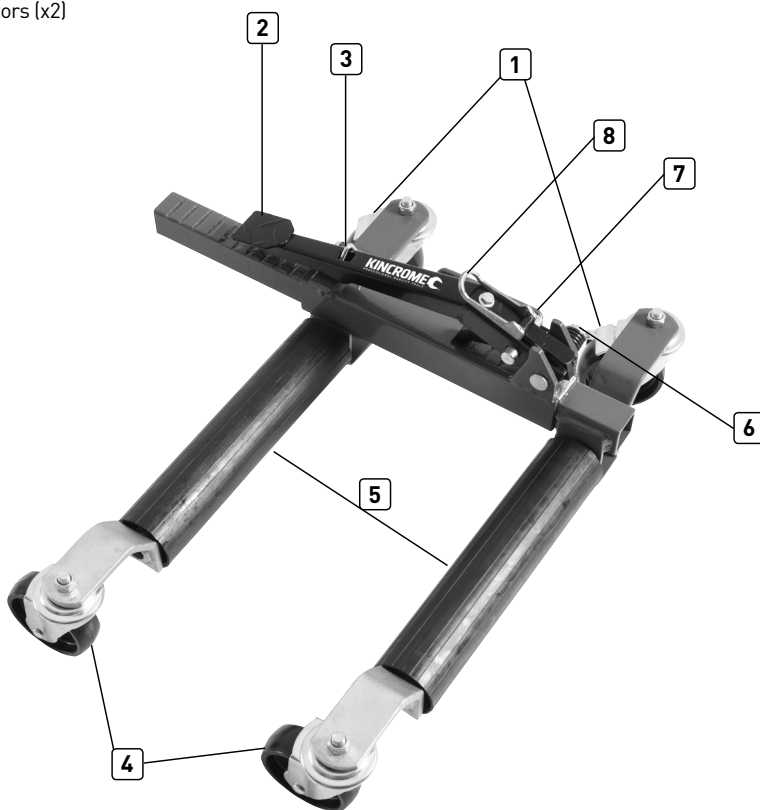

Specifications

Model No	K12190
Rated Capacity	684kg
Max Tyre Width	330mm
Adjusting Range	285-660mm
Castor Material Construction	Nylon
Weight	14.7kg

General Safety Warnings

Save all **WARNINGS** and instructions for future reference.

Read and understand the entire contents of this manual before attempting to use the Vehicle Positioning Jacks.

The **WARNINGS**, cautions and instructions discussed in this instruction manual cannot cover all possible conditions or situations that could occur. It must be understood by the operator that common sense and caution are factors which cannot be built into this product, but must be supplied by the operator.

Preparing Work Area

Before using vehicle positioning jacks, it is important to prepare work area properly.

Follow this procedure each time the vehicle positioning jacks are used to help prevent property damage and or serious injury.

1. **Keep work area clean, free of clutter and well lit. Cluttered and dark work places can cause accidents.**
2. **Keep children and bystanders away while operating this jack. Distractions can cause you to lose control, so visitors should remain at a safe distance from the work area.**
3. Be aware of all power lines, electrical circuits, water pipes and other mechanical hazards in your work area, particularly those hazards below the work surface hidden from the operators view that may be unintentionally contacted and may cause personal harm or property damage.
4. **Be alert of your surrounds.** Using Jacks in confined work areas may put you dangerously close to cutting tools and rotating parts.

Personal Safety

1. **Stay alert. Watch what you are doing and use common sense when operating the tool. Do not use the tool while tired or under the influence of drugs, alcohol, or medication.** A moment of inattention while operating the tool increases the risk of injury to persons.
2. **Dress properly. Do not wear loose clothing or jewellery. Contain long hair. Keep hair, clothing and gloves away from moving parts.** Loose clothes, jewellery, or long hair increases the risk of injury to persons as a result of being caught in moving parts.
3. **Do not overreach. Keep proper footing and balance at all times.** Proper footing and balance enables better control of the tool in unexpected situations.
4. **Use safety equipment.** A dust mask, non-skid safety shoes and a hard hat must be used for the applicable conditions.
5. **Always wear eye protection.** Wear ANSI-approved safety goggles.
6. **Have a qualified person maintain the equipment in good condition. Keep it clean for best and safest performance.**
7. **If the equipment needs repairing and/or there are parts that need to be replaced, have it repaired by authorized technicians. Only use the replacement parts supplied by the manufacturer.**
8. **Dress properly. Do not wear loose clothing, dangling objects or jewellery.**
9. **Modifications must not be carried out or accessories added.**

IMPORTANT SAFETY INFORMATION

1. **DO NOT** operate the jacks on surfaces which are not leveled. Jack must be used on hard, flat surfaces only. The vehicle may shift as soon as the jacks lift the wheel from the surface.
2. **DO NOT** overload the jack beyond the Maximum Load Capacity which is 684kg per unit. Refer to your vehicles manual for weight of your car.
3. **DO NOT** start the vehicles engine, or drive while the jacks are in use. Jacks are designed for hand manoeuvring of vehicles only.
4. **DO NOT** use the jacks to lift tyres wider than 13" or 330mm. Refer to the side wall of your tyres. (eg. 265/40R18 tyres are 265mm wide).
5. **DO NOT** attempt to push the jack over obstacles. They are designed to be used on hard, smooth and flat level surfaces only.
6. After lifting, be sure to **ALWAYS** secure the jacks in place with the locking pin. To lower the vehicle, remove the locking pin before using the release valve.
7. **DO NOT** force the tool. Tools do a better and safer job when used in a manner for which they are designed. Plan your work, and use the correct tool for the job.
8. Store idol tools. When tools are not in use, store in a dry, secure place out of reach of children. Inspect tools for good working conditions prior to storage and and before re-use.
9. Modifications must not be carried out or accessories added. **ONLY** use accessories which are recommended by the manufacturer for your model. Accessories that may be suitable for one tool may create a risk of injury when used on another tool.

10. NEVER leave the jacks unattended, while in use.
11. Use as intended only. Do not use for aircraft purposes. Use only in pairs.
12. Inspect before every use; do not use if parts are loose or damaged.
13. Stay alert. Watch what you are doing, and use common sense when operating the Vehicle Positioning Jack (VPJ). Do not use while tired or under the influence of drugs, alcohol, or medication. A moment of inattention while operating VPJ may result in serious personal injury.
14. Do not allow anyone in the vehicle while using the VPJ. Do not start the vehicle while it is on VPJ. Keep all bystanders a safe distance away from the vehicle.
15. This product is not a toy. Do not allow children to play with or near this item.
16. The warnings, precautions, and instructions discussed in this manual cannot cover all possible conditions and situations that may occur. The operator must understand that common sense and caution are factors, which cannot be built into this product, but must be supplied by the operator.

Unpacking

When unpacking the Vehicle Positioning Jack, carefully inspect each component for damage that may have occurred during transit.

1. Check for any missing or damaged components and report these to the supplier for instructions.
2. Ensure all packaging materials are disposed of as per your local council guide lines.

Assembly

1. Assemble on a flat, level, hard and smooth surface
2. Both castors need to be fitted to each base assembly, attach Casters, making sure the square nuts seat inside the square openings

OPERATION



WARNING!: Only use the vehicle positioning jack on a flat & leveled surface.
Ensure your work area is clean and tidy before use of the vehicle positioning jack.

1. Position the vehicle Positioning Jack beside the vehicles wheel (Fig 7).
2. Remove the pedal retaining clip (3) (Fig 8).
3. Ensure the rear locking castors (1) are UNLOCKED in the OFF position (Fig 9).
4. Ensure the Lever (8) is in the down position (Fig 10.)
5. Spread the jack arms apart until they fit the vehicle wheel (Fig 11).
6. Ensure tyres are sitting on the plastic rollers (6) (Fig 12).
7. Push the Lever (8) in the up position (Fig 13).
8. Pump the foot pedal (2) until the tyre is raised from the ground. (Fig 14).
9. Repeat steps 1 - 8 on the remaining wheels you wish to lift.
10. Once the vehicles wheels are raised on both sides/or all four wheels (and the rear castors (1) are not locked), the vehicle can easily be moved by pushing on the side of the vehicle to the desired position (Fig 15).
11. Once the vehicle has been located to the desired location, ensure both of the rear locking castors (1) are LOCKED.



WARNING!: Be ready for any movement the vehicle may make when the other tyre(s) come off the ground. Ensure that you have sufficient assistance and manpower to safely guide and control the vehicle.

WARNING!: Stay clear of any sloping areas or entry ramps, however shallow they may appear. Sufficient space should be allowed between the side of the vehicle and an adjacent wall for the vehicle to be withdrawn from its location in a sideways manner.



Fig.7



Fig.8



Fig.9



Fig.10



Fig.11



Fig.12



Fig.13



Fig.14



Fig.15

12. To lower the vehicle, Move the Lever to the down position, then depress and release the Foot Pedal. Once tyre is on the ground, spread Arms and remove Vehicle Positioning Jack. Push arms together, then depress Foot Pedal all the way and secure with Pedal Lock. (Fig 17).
13. Grasp the grab handle and slide the jacks from underneath the vehicles wheels (Fig 18).

CARE & MAINTENANCE

Caution: These procedures are in addition to the regular checks and maintenance explained as part of the regular operation of the tool. Lubrication of this product is critical. Any contaminants such as dirt, rust, etc. may damage internal components of the ratcheting assembly.





1. **BEFORE EACH USE**, inspect the general condition of the tool. Check for:
 - a) loose hardware or housing.
 - b) misalignment or binding of moving parts.
 - c) cracked or broken parts.
 - d) any other condition that may affect its safe operation.
2. When not in use, store the equipment in a dry location with the vehicle positioning jacks fully retracted with the pressure released via the pump release valve (4).
3. Periodically check the unit for signs of rust or corrosion. Clean exposed areas with a clean oiled cloth.

PERIODICALLY:

1. Lubricate the ratcheting arm piston, linkage and foot pedal with a light machine oil.
2. Lubricate the castors and axles with bearing grease.
3. Clean all the surfaces regularly and maintain all labels and warnings on the vehicle positioning jacks.
4. Clean the castors regularly to ensure they are free from dirt etc. before use. Doing so will prevent possible damage.

Caring For The Environment

When a tool is no longer usable it should not be disposed of with household waste, but in an environmentally friendly way. Please recycle where facilities exist. Check with your local council authority for recycling advice. Recycling packaging reduces the need for landfill and raw materials. Reuse of recycled material decreases pollution in the environment. Please recycle packaging where facilities exist. Check with your local council authority for recycling advice.

Symbol	Property or statement
kg	Weight in kilograms
	WARNING marking concerning Risk of Eye Injury. Wear ANSI-approved eye protection.
	WARNING marking concerning Risk of Hearing Loss. Wear hearing protection.
	WARNING marking concerning, Risk of Respiratory Injury. Wear NIOSH-approved dust mask/respirator.
WARNING or 	Marking concerning/Risk of Injury.

Trouble Shooting

Symptom	Cause	Remedy
Pump unit will not work	1. Ensure lever [8] is in the up position.	1. Push lever [8] to the up position

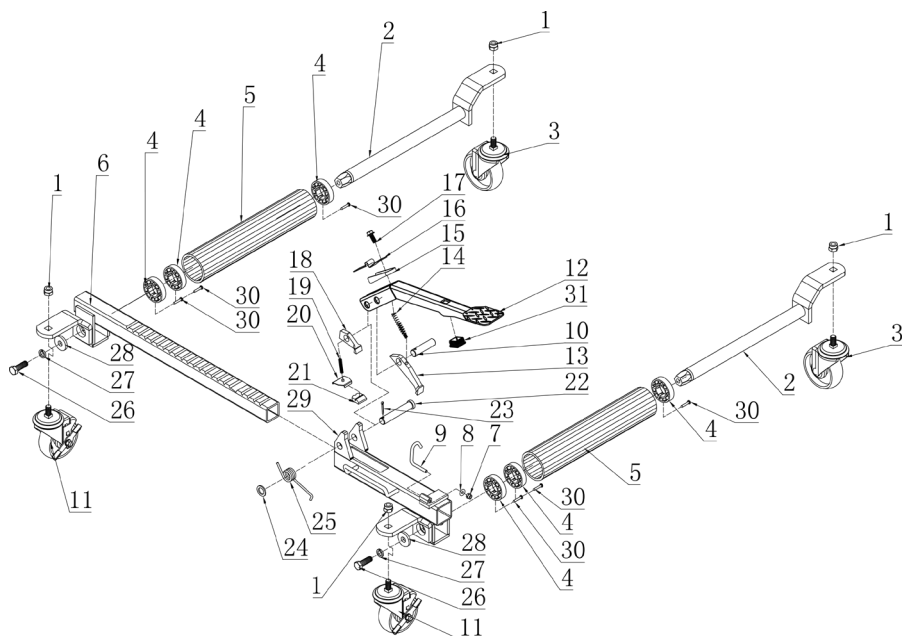

No.	Description	Qty.	No.	Description	Qty.
1	Lock Nut	4	17	Bolt	1
2	Rod A'ssy	2	18	Rear Claw	1
3	Caster	2	19	Spring	1
4	Rod Race Way	6	20	Fixed Plate	1
5	Roller (Nylon)	2	21	Limit Block	1
6	Movable Sleeve A'ssy	1	22	Lock Pin	1
7	Lock Nut	1	23	Cotter Pin	1
8	O Ring	1	24	Washer	1
9	Pedal Lock Pin	1	25	Spring	1
10	Lock Pin	1	26	Bolt	2
11	Caster with brake	2	27	Lock Washer	2
12	Foot Pedal A'ssy	1	28	Washer	2
13	Front Claw	1	29	Fixed Sleeve A'ssy	1
14	Spring	1	30	Screw	6
15	lock	1	31	Rubber Pad	1
16	Spring Plate	1			

PLEASE NOTE: Part number K12100-9 & K12100-9L are for the Polyurethane Castors.
 Part number K12100-20 & K12100-20L are for the Nylon Castors.

Office Contact Details:**Phone:** +61 3 9730 7100**Fax:** 1300 556 005**Email:** enquiries@kincrome.com.au**Website:** www.kincrome.com.au**Notes:****WARRANTY**

Warranty given by Kincrome Australia Pty Ltd of 3 Lakeview Drive, Caribbean Park, Scoresby, Victoria (Tel +61 3 9730 7100). The applicable warranty period (12 months) commences on the date that the product is purchased. If this product has materials or workmanship defects (other than defects caused by abnormal or non warranted use) you can, at your cost, send the product to place of purchase, an authorised Kincrome service agent or one of Kincromes addresses for repair or replacement. Your rights under this warranty are in addition to any other rights you have under the Australian Consumer Law or other applicable laws. Our goods come with guarantees that cannot be excluded under the Australian Consumer Law. You are entitled to a replacement or refund for a major failure and compensation for any other reasonably foreseeable loss or damage. You are also entitled to have the goods repaired or replaced if the goods fail to be of acceptable quality and the failure does not amount to a major failure. For further details please visit www.kincrome.com.au or call us. Due to minor changes in design or manufacture, the product you purchase may sometimes differ from the one shown on the packaging.

KINCROME 
PROFESSIONAL QUALITY TOOLS

www.kincrome.com.au