



HIGH LIFT HYDRAULIC TRANSMISSION JACK

K12110

Distributed by Kincrome Group www.kincrome.com.au

Owner's Assembly and Operating Manual

SPECIFICATIONS	2
IMPORTANT SAFETY INFORMATION	3
UNPACKING AND ASSEMBLING JACK	3
Unpacking Carton	3
Assembly.....	3
Testing Operation	3
OPERATING JACK.....	3
Preparing Work Area	3
Using Transmission Jack	4
Working on Vehicle	5
MAINTENANCE AND STORAGE	5
Lubricating.....	5
Maintaining Oil Level	5
Important Note:	5
Adding Oil:.....	5
Replacing Oil:.....	5
Priming jack.....	5
Cleaning	5
Storage.....	6
Repairing Jack	6

SPECIFICATIONS

Working Load Limit	600 KG
Height Lowered	1100 mm
Height Raised	1900 mm
Total Weight:	40 KG
Part Number	K12110

IMPORTANT SAFETY INFORMATION

The use of a transmission jack has inherent dangers to avoid risk of personal injury or property damage make sure you are fully aware of the operating instructions for this product, the recommendations in the vehicle owners manual prior to using this tool. Do not exceed maximum lifting capacity of 600 kg. This Transmission jack is intended for automotive use only. Be aware that large or heavy transmissions may exceed the stated capacity check vehicle owners manual or contact the transmission manufacturer. Do not use for any other purpose except the raising and lower of transmission, gear boxes, or differentials. Never use to raise a vehicle, structure or building, do not lift any human load and never ride on the Transmission jack.

UNPACKING AND ASSEMBLING JACK

Unpacking Carton

Place carton in a clear, open area such as garage floor. Remove ram, leggs, wheels and bolts from carton.

Assembly

Transmission jack requires the legs x2 to be bolted to either side of the pump block. The wheels are then bolted to the four corners of the legs. Once the transmission jack is mobile, the lifting fork can be placed onto the lifting arm.

The basic lifting fork can be replaced with an adjustable transmission jack mount or an adjustable oil pan holder. These accessory items can be sourced by contacting your place of purchase or Kincrome Australia for availability.

Testing Operation

Briefly test jack operation as follows BEFORE using to lift any load. Turn release valve clockwise or counter clock wise allows jack to be raised and lowered. To raise jack, twist release valve completely clockwise until it stops. Do not force or tighten beyond this point. Pump foot pedal a few times to raise jack about halfway. If jack does not begin to rise after a few pumps, check to make sure the release valve is firm. With jack raised, twist valve slowly counterclockwise to lower jack. A normal hissing sound may be heard as jack lowers and pressure in hydraulic cylinder is released.

OPERATING JACK

Preparing Work Area

Before using the transmission jack, it is important to prepare work area properly. Follow this procedure each time the transmission jack is used to help prevent property damage and or serious injury.

- 1.) Thoroughly inspect jack for damage or wear before each use. Briefly test operation of unloaded jack before using to lift any load. If jack is damaged or is malfunctioning DO NOT LIFT ANY LOAD until the

problem is corrected.

- 2.) Consult vehicle owner's manual for safety precautions, Transmission weight, and location of support areas on transmission. The working load limit of the transmission jack is 600 kg. **NEVER EXCEED WORKING LOAD LIMIT OF TRANSMISSION JACK.**
- 3.) Clear children and others from work area before commencing work. Another adult should be nearby for extra safety and assistance but must be clear of vehicle as it is worked on.
- 4.) Clear obstructions from work area. Working in tight or cluttered work areas is dangerous.
- 5.) Be sure transmission jack and vehicle are on solid, level ground such as paved or concrete driveway or garage floor so the jack is free to roll. Uneven or sloped surfaces create hazardous working conditions and dangerously impeded the function of the jack.
- 6.) With vehicle in proper position, set vehicle's parking brake or emergency brake and put gearshift in park (manual transmissions should be placed in lowest gear). **TURN VEHICLE IGNITION OFF AND TO THE "LOCK" POSITION** making sure steering wheel locks.
- 7.) Chock all wheels of vehicle to prevent vehicle rolling. Using wedge-shaped blocks that tyre cannot roll over, position one chock tight against the tyre in both forward and reverse rolling paths.
- 8.) Plan location of transmission jack beneath vehicle, making sure transmission jack will be contacting only the transmission area of vehicle. Consult vehicle owner's manual for recommended areas.

Using Transmission Jack

- Lifting a transmission, gearbox, or differential using a transmission jack can be dangerous. This transmission jack is designed and intended for use by properly trained and experienced personnel only. If you are not familiar with the proper and safe operation of a transmission jack, do not use until proper training and knowledge have been obtained.

Follow all instructions and precautions below.

- 1.) With lifting arm completely lowered, roll jack into position beneath the transmission of the vehicle.
- 2.) Twist release valve completely clockwise to close release valve. Slowly pump foot pedal until transmission fork just begins to contact support area on underside of transmission.
- 3.) Inspect position of transmission fork making sure it is centered and properly engaging the transmission.
- 4.) Pump handle again until transmission fork is firm against the transmission.
- 5.) Ensure Transmission is securely attached to the transmission fork, the load may slip or fall if not securely restrained.
- 6.) Undo transmission from vehicle
- 7.) Undo release valve, very slowly turn counter clockwise. Slowly and smoothly lower transmission excessive speed or jerky motion can cause the transmission to slip leading to property damage or personal injury.

Working on Vehicle

Any transmission being supported by a jack creates a potentially hazardous working environment.

Never place any part of your body beneath a transmission supported by a jack. Be careful of forces applied to transmission such as torque on a nut or bolt these forces could cause transmission to become unstable on transmission fork.

MAINTENANCE AND STORAGE

Lubricating

Moving parts on jack should be lubricated occasionally with a light machine oil to maintain efficient operation. Apply oil to joints on lift arm hinges, push rods, handle base, caster wheels, front wheels, and adjusting screws, wipe away excess oil with soft cloth.

Maintaining Oil Level

Important Note:

When adding or replacing oil, always use a good grade Hydraulic Jack Oil. Avoid mixing types of oil. DO NOT use Brake Fluid, Alcohol, Glycerin, Detergent, Motor Oil or Dirty Oil, Improper fluid can cause serious internal damage to Jack.

Adding Oil:

With ram fully lowered & jack on level ground, remove Air Vent Valve. Oil level should be at the filler hole. If low, add oil until it start to leak back out then close air vent valve.

Replacing Oil:

For better performance & longevity, replace oil supply once a year. To drain oil, open Air Vent Valve and loosen the release Valve by turning counterclockwise. BE VERY CAREFUL not to permit dirt or foreign matter to get into the system. Tilt the jack until all old oil has drained out, refill with good grade Hydraulic Jack Oil close Air Vent Valve wipe away any spilt fluid. Prime jack before lifting a load.

Priming jack

If the transmission jack is not lifting as intended or hydraulic fluid replacements has just been completed then the jack needs to be primed/bleed to ensure no air is in the hydraulic system. Remove the air vent valve, undo the release valve and allow the saddle to lower to the lowest position. Pump the foot pedal at least ten (10) times to force air from the system. Wipe away any spilled oil and replace the air vent valve, tighten the release valve and test the unit.

Cleaning

Jack should be wiped clean with soft cloth only. Do not use gasoline, kerosene, or other such solvents or any abrasive cleanser as cleaning agents and solvents will cause deterioration of the hydraulic seals.

Storage

Before storage, twist release valve 1-1/2 turns counterclockwise to release pressure in hydraulic cylinder. Store jack level, in a clean environment, preferably indoors, in a dry area to protect jack from moisture.

Repairing Jack

There are no user serviceable parts except as outlined above. Only trained, licensed and certified repair personnel should attempt any repairs or replacing of parts. Any modifications to this jack, except those performed by the manufacturer, or their designee, will void all warranties both written and implied.

Exploded Diagram

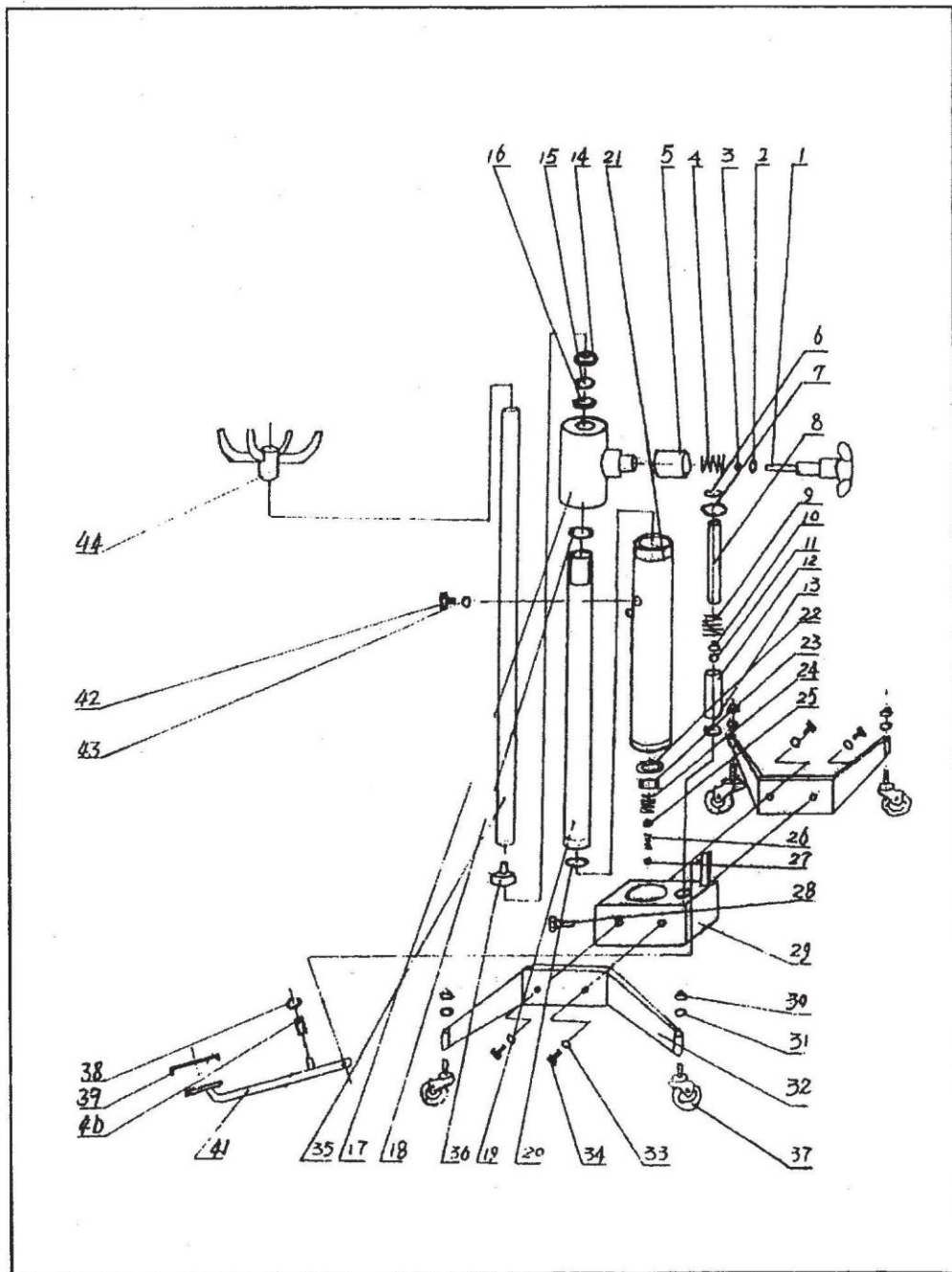

PARTS LIST

NO	DESCRIPTION	QTY	NO	DESCRIPTION	QTY
1	Split pin	1	23	Bolt	1
2	o-ring	1	24	Spring	1
3	Ball	1	25	Ball	1
4	Spring	1	26	spring	1
5	Bush	1	27	ball	1
6	Circlips	1	28	Screw	1
7	Cover	1	29	pump	1
8	Piston	1	30	Nut M12	4
9	Spring	1	31	Washer Φ 12	4
10	o-ring	1	32	Under carriage	2
11	o-ring	1	33	washer Φ 10	4
12	Pump unit	1	34	bolt	4
13	Pad	1	35	Piston	1
14	o-ring	1	36	Plunger	1
15	o-ring	1	37	Universal wheel	4
16	y-ring	1	38	Circlips	1
17	Cylinder head	1	39	Cover	1
18	o-ring	1	40	Bush	1
19	Cylinder	1	41	Pedal	1
20	pad	1	42	Bolt	1
21	Reservoir	1	43	o-ring	1
22	o-ring	1	44	Fork	1

Warranty given by Kincrome Australia Pty Ltd of 3 Lakeview Drive, Caribbean Park, Scoresby, Victoria (Tel 1300 657 528). If this product has materials or workmanship defects (other than defects caused by abnormal or non warranted use) you can , at your cost, send the product to place of purchase, an authorized Kincrome service agent or one of Kincrome's addresses for repair or replacement. Your rights under this warranty are in addition to any other rights you have under the Australian Consumer Law or other applicable laws. Our goods come with guarantees that cannot be excluded under the Australian Consumer Law. You are entitled to a replacement or refund for a major failure and compensation for any other reasonably foreseeable loss or damage. You are also entitled to have the goods repaired or replaced if the goods fail to be of acceptable quality and the failure does not amount to a major failure.

For further details please visit www.kincrome.com.au or call us

Distributed by Kincrome Tools and Equipment

www.kincrome.com.au

3 Lakeview Drive Scoresby Victoria

Phone: 1300 657 528

